

Courses & Dist^s all round

S 75 E	22 1/4
S 14 E	102
S 52 1/2 E	48
N 15 W	54
N 4 W	12
N 35 E	34 1/2
S 85 E	34
S 65 E	53
S 10 E	86
S 87 W	80
S 4 W	27 1/2
S 17 W	15
S 58 W	32
S 18 E	122
N 43 E	40
N 32 W	18
N 13 W	40
N 61 E	216
N 31 W	108
N 38 E	5
N 19 W	23
N 11 W	70
N 53 W	7 1/4
N 9 W	14
N 56 W	5
N 25 W	76
N 83 E	18 1/2
N 51 W	75 1/2
N 59 W	13

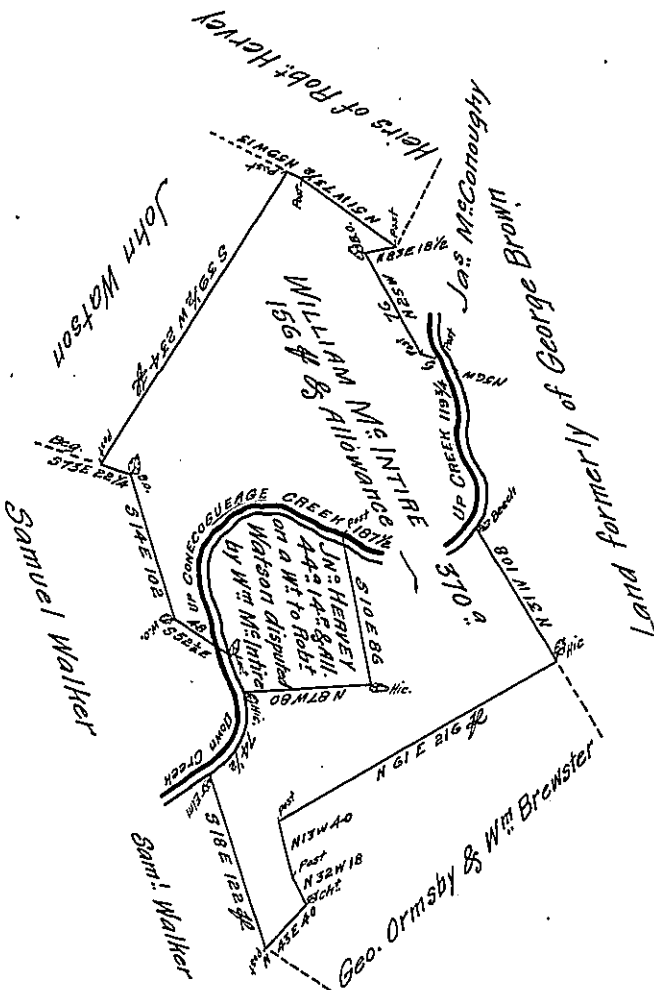

The above largest Draft describes a Tract or Parcel of Land situate in Fannet Township ^{formerly} in the County of Cumberland, but now in the County of Franklin. Containing three hundred and seventy Acres and 156 Perches and the allowance of Six ~~4~~ Cent. for Roads &c. Survey'd March 27th 1793 in pursuance of two Applications, one of William M^cIntire N^o 1685 and the other of Jean M^cIntire N^o 1688, both both bearing Date the 27th Day of October 1766. --- Said William M^cIntire also claims the survey of 44^{ac} & 14^p inserted on this Draft, on the Application of Jean M^cIntire, as formerly noted on the return thereof.

Matt^r Henderson, D. S.

To Daniel Brodhead Esquire }
 Surveyor General of Pennsylvania }

IN TESTIMONY that the above is a copy of the original remaining on file in the Department of Internal Affairs of Pennsylvania, made conformably to an Act of Assembly approved the 16th day of February, 1833, I have hereunto set my Hand and caused the Seal of said Department to be affixed at Harrisburg, this thirtieth day of January 1907.

Isaac B. Parsons
 Secretary of Internal Affairs.